

Location Plan



KANKARIYA
PROPERTIES
BRINGING YOU REAL ESTATE
Constructions Horticulture

Member
CREDAI
AURANGABAD

Office Address

2nd floor, Raj Tower,
Opp. Nupur Theatre,
Jalna Road, Aurangabad.

Architect

Balasaheb Raut
86259 23827

Engineer

Pramod Mote
88558 44438

Phase 1

RERA Regi. No. - P51500001817

Phase 2

RERA Regi. No. -

For Booking Contact : 77989 77796, 98235 44007, 8888891221

REERA Registered Project

कदत
सृष्टी

Gut No. 70,
Near to Shendra MIDC

1 BHK FLATS



**मोठी स्वप्नं,
छोट्या बजेट मध्ये !**

The contents of this brochure are purely conceptual and have no legal binding on us. Developers reserve the right to amend the layout, plans, number of floors, number of flats, elevation, colour scheme, specifications and amenities etc.



Phase I



Ground Floor Plan



Stilt First Floor Plan



Stilt Second Floor Plan



मोठी स्वप्नं, छोट्या बजेट मध्ये !

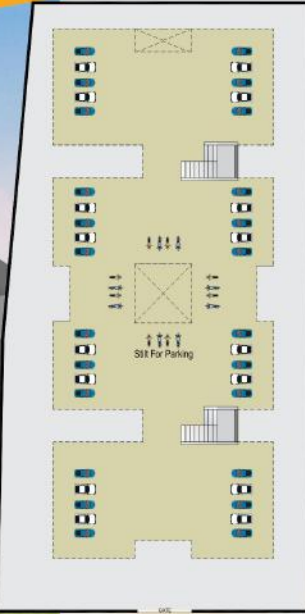

Parking Floor Plan



Stilt Ground, Stilt Second Floor Plan



Stilt First Floor Plan



Disclaimer: The project details have been uploaded and payment has been done on MAHARERA website for RERA registration of ekdant shrushti ph 2. It takes certain time for generation of the registration no and it will be immediately disclosed when we get the unique registration no.



Project Highlights

- Negligible society maintenance
- Great property investment as Shendra MIDC and AURIC city at approx 2kms
- Project sanctioned by collector and situated in shendra jahangir gram panchayat
- Most competitive price in comparison to surrounding projects
- Property owned and developed by kankariya properties with no project loan and registered with MAHARERA ensuring 100% clear title of property.

Amenities

- **Complete Branded Fittings**
Earthquake resistant building built in ISI marked Steel & Cement
- **Flooring and Tiling**
2x2 vitrified tiles
Designer bathroom and kitchen wall tiles
- **Paint**
One coat putty and two coat of Branded Paint
- **Electrification**
High density heat resistant wires and branded ISI marked switches
- **Street lights**
- **Plumbing & Sanitary**
CPVC concealed fittings
Branded ISI marked Sanitary & CP fittings
- **Door & Hardware**
Flush door with branded designer laminate
Branded ISI marked hardware
- **Security**
5 feet compound wall
3 track aluminum windows with mosquito net & MS grill
- **Approx 100 feet deep well**
- ensuring water availability
- **Septic tank for solid waste and**
- drainage line for liquid waste

